

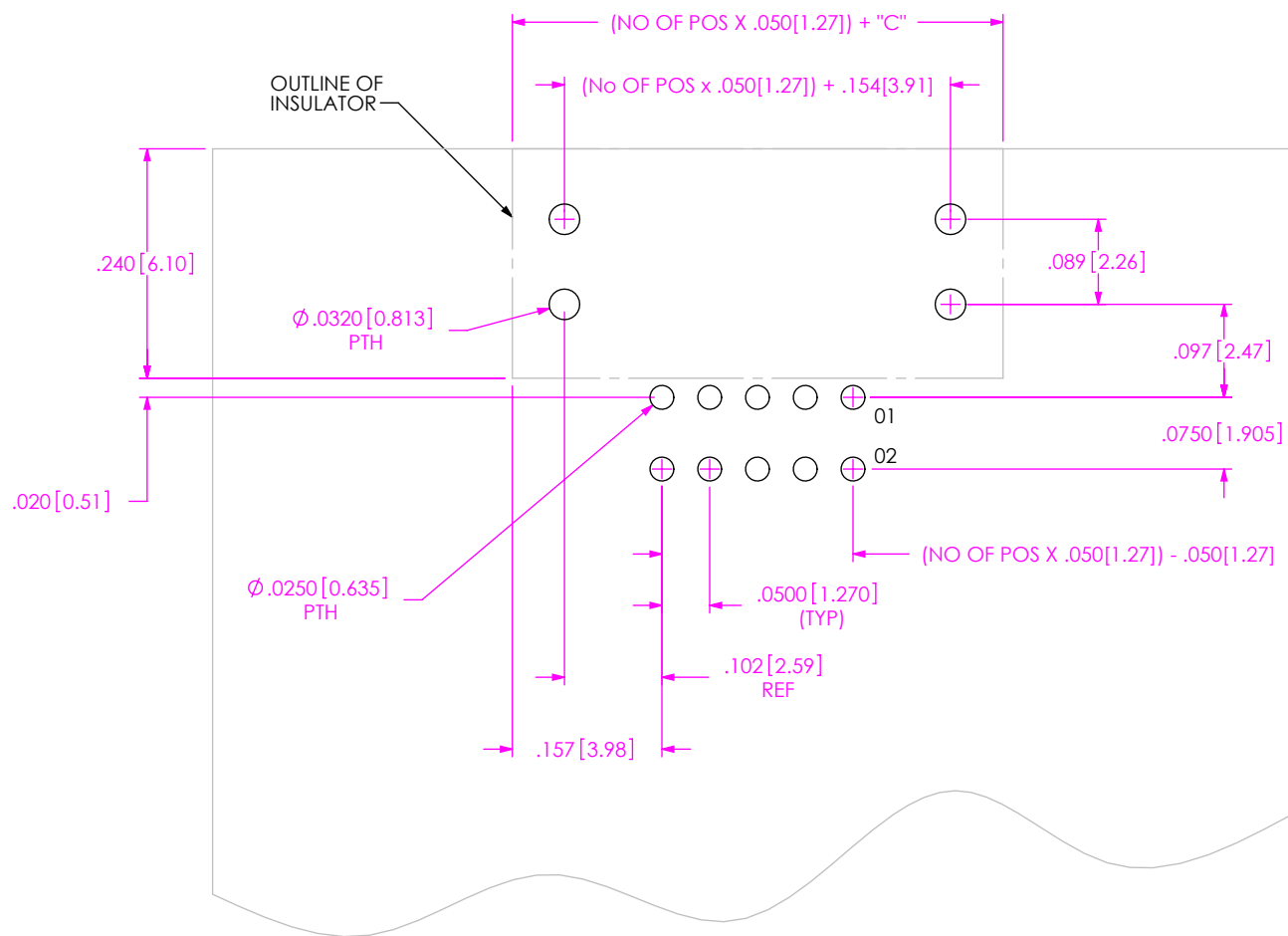

OPTION	"A"	"B"	"C"
-A	.056 [1.42] NPTH	.075 [1.91]	.125 [3.18]
-LC	.047 [1.19] NPTH	.075 [1.91]	.125 [3.18]
-SA	.038 [0.97] NPTH	.075 [1.91]	.125 [3.18]
-WT	.033 [0.84] PTH	.154 [3.91]	.263 [6.68]
-REX	N/A	N/A	.263 [6.68]
-RA	N/A	N/A	.125 [3.18]
-DS	.055 [1.40] NPTH	.075 [1.91]	.600 [15.24]

santec

SHEET 1 OF 5



PROPRIETARY NOTE
 THIS DOCUMENT CONTAINS CONFIDENTIAL AND PROPRIETARY INFORMATION AND ALL DESIGN, MANUFACTURING, REPRODUCTION, USE, PATENT RIGHTS AND SALES RIGHTS ARE EXPRESSLY RESERVED BY SAMTEC, INC. THIS DOCUMENT SHALL NOT BE DISCLOSED, IN WHOLE OR PART, TO ANY UNAUTHORIZED PERSON OR ENTITY NOR REPRODUCED, TRANSFERRED OR INCORPORATED IN ANY OTHER PROJECT IN ANY MANNER WITHOUT THE EXPRESS WRITTEN CONSENT OF SAMTEC, INC.

samtec

520 PARK EAST BLVD, NEW ALBANY, IN 47150
 PHONE: 812-944-6733 FAX: 812-948-5047
 e-Mail: info@SAMTEC.com code: 55322

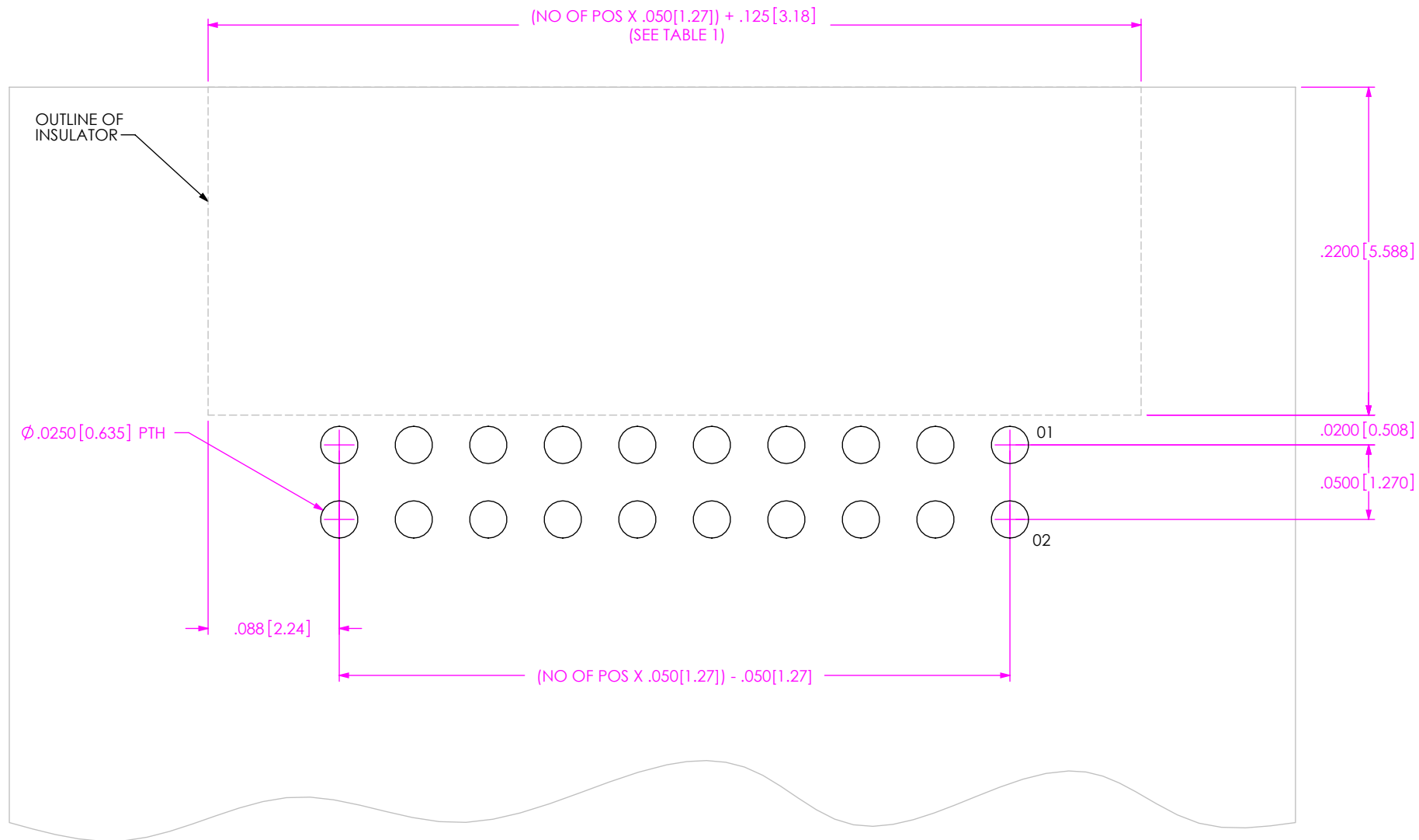

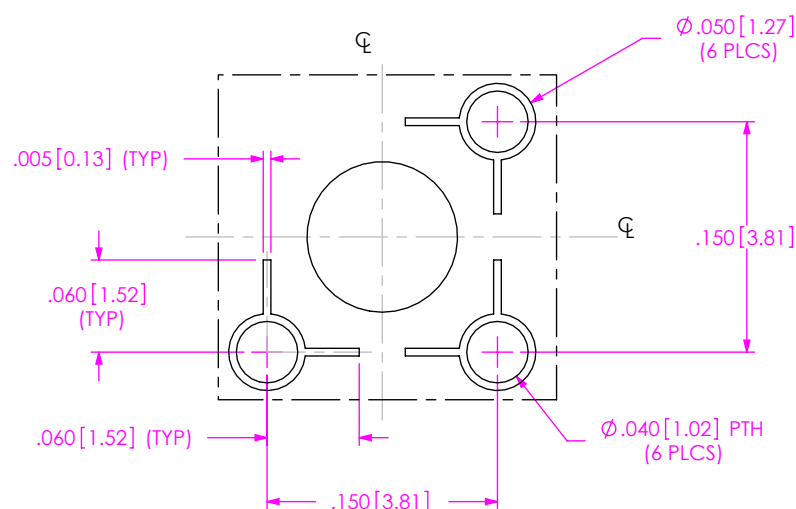
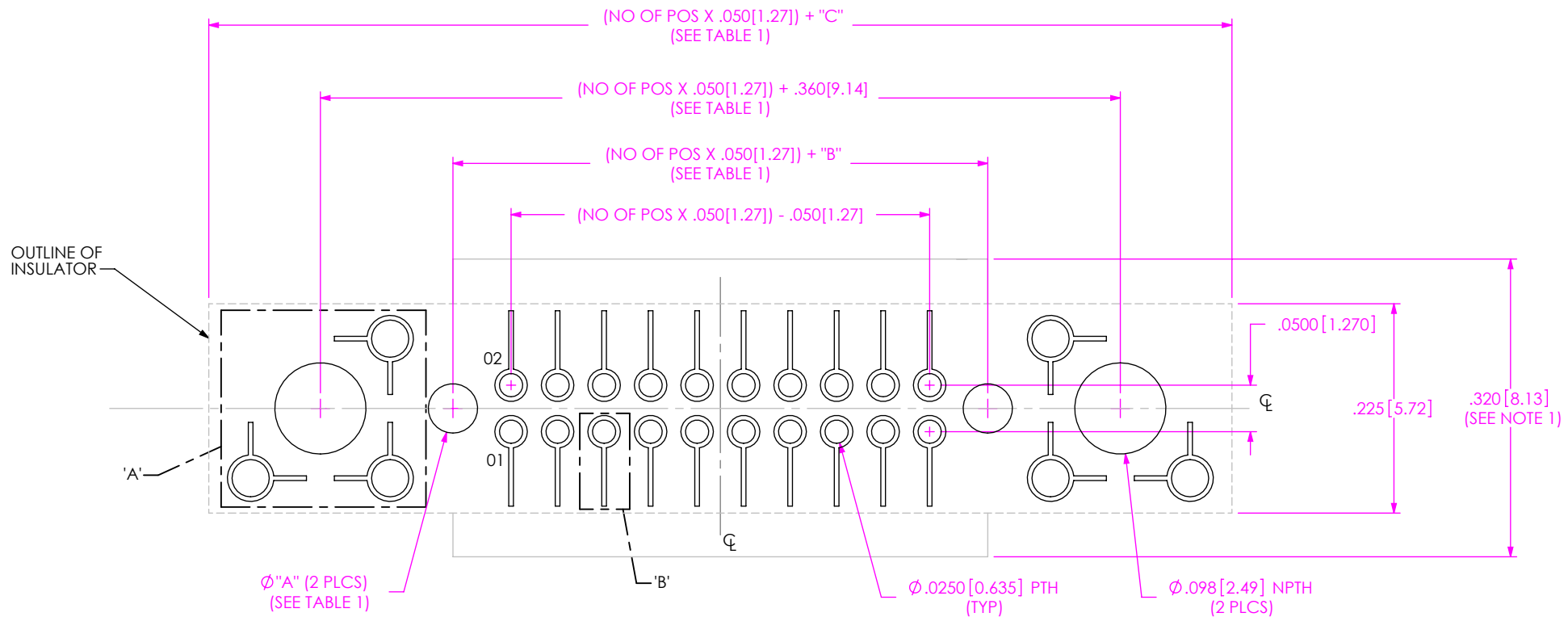

DETAIL 'A'
SCALE 8 : 1

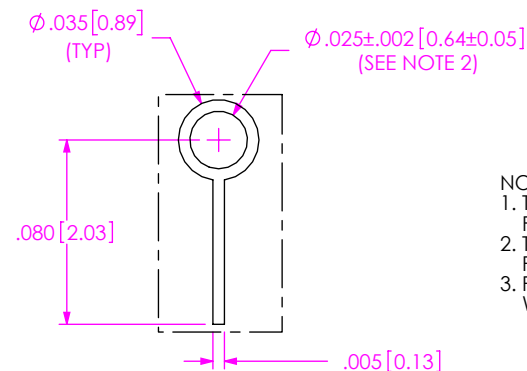

DETAIL 'B'
SCALE 12 : 1

NOTES:

1. THIS REGION REPRESENTS A KEEP OUT AREA NEEDED FOR PASTE-IN-HOLE PROCESSING ONLY.
2. THIS TOLERANCE APPLICABLE FOR PASTE-IN-HOLE PROCESSING ONLY.
3. PASTE-IN-HOLE PROCESSING MAY NOT BE POSSIBLE WITH PCB THICKNESS GREATER THAN 1.57MM [.062].

* PROPRIETARY NOTE *

THIS DOCUMENT CONTAINS CONFIDENTIAL AND PROPRIETARY INFORMATION AND ALL DESIGN, MANUFACTURING, REPRODUCTION, USE, PATENT RIGHTS AND SALES RIGHTS ARE EXPRESSLY RESERVED BY SAMTEC, INC. THIS DOCUMENT SHALL NOT BE DISCLOSED, IN WHOLE OR PART, TO ANY UNAUTHORIZED PERSON OR ENTITY NOR REPRODUCED, TRANSFERRED OR INCORPORATED IN ANY OTHER PROJECT IN ANY MANNER WITHOUT THE EXPRESS WRITTEN CONSENT OF SAMTEC, INC.

samtec

520 PARK EAST BLVD, NEW ALBANY, IN 47150
PHONE: 812-944-6733 FAX: 812-948-5047
e-Mail: info@SAMTEC.com code: 55322

[illegible]**samtec**

— SHEET 5 OF 5 —